

FOR FURTHER RING DETAILS SEE: RC7925-RS

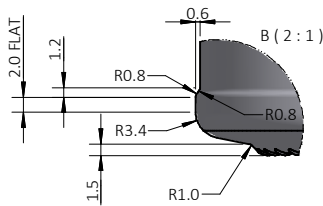
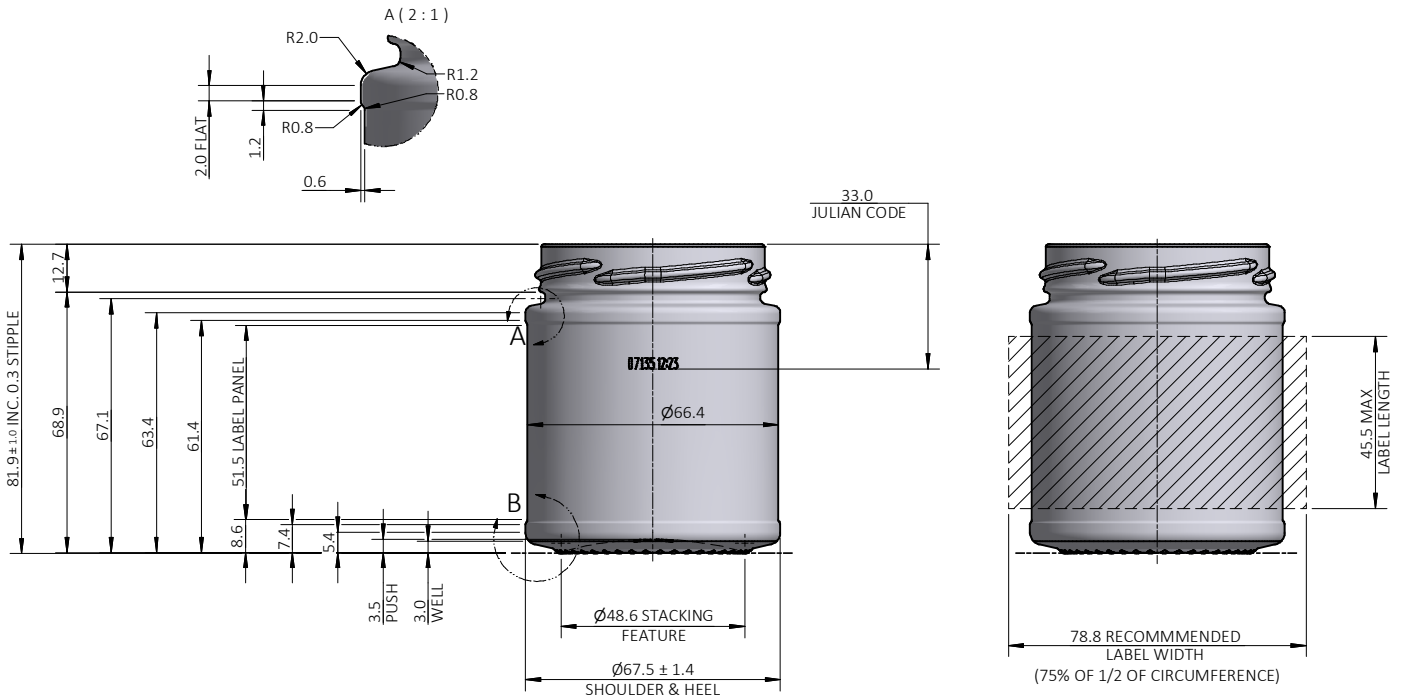

BASE EMBOSHING TO BE 5.0 TALL INCLUDING:

SET NUMBER
 FACTORY CODE
 LNMC GRID (3.0)

(42) BAR STIPPLES 3.0 LONG TO STD: 5325-H

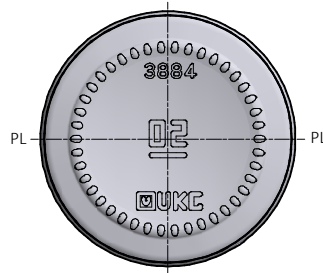

DESCRIPTION		CAPACITY AT FILL POINT		APPROX. GLASS WEIGHT		GLASS CONTAINER SPECIFICATION		J			
206ml FOOD JAR		ml		145 g		STD FLINT		I			
PRODUCT		CAPACITY TOLERANCE		GLASS COLOUR		THIS DRAWING IS THE PROPERTY OF VERALLIA UK. REPRODUCTION AND DISTRIBUTION PROHIBITED WITHOUT OUR PRIOR WRITTEN PERMISSION. NON-TOLERANCED DIMENSIONS ARE CONSTRUCTION DIMENSIONS GIVEN FOR INFORMATION ONLY.		H			
FOOD		± 4.2 ml		STD FLINT				G			
PE No. 10459		VACUITY (excl. FITMENT or CORK)		FINISH DESCRIPTION				F			
PROPOSAL No. 1		%		63 FD138				E			
CUSTOMER		FILL BELOW TOP		FINISH SPECIFICATION				D			
GENERAL TRADE		mm		RC7925-RS				C			
DATE		MEASURING CONTAINER		RING NECK DIAMETER				B			
10.02.25		3 ±		57.0mm				A		MOULD No ADDED, BAR STIPPLE WAS CRESCENT	
DRAWN MA		ml		MOULD No.		3884		REV.		RN GCR 01.03.2025	
CHECKED GCR		BRIMFUL CAPACITY						DETAILS		DRN CKD DATE	
SHEET 1 OF 1		206 ml						SPECIFICATION No.		3884-7925	
SIZE A2		ml									
3D MODEL REF. 3884-7925_REV A_FOOD_JAR_206ml.ipt		ml									
COLOUR COATING NO		VERTICAL LOAD 2000 N		THERMAL SHOCK STD °C		REFILLABLE NO		MAX. INT. PRESSURE N/A		BAR @20°C PASTEURISED YES	